

March 11, 2010

Vaastu recommendation: The south west (SW) portion of the house/business should not have any door.

Analysis: The above is one of the core recommendations in Vaastu. The presence of a door in the SW corner (either west facing or south facing) is not considered beneficial to a business or to a house. While it is recommended that this door be closed at all times (so that its functionality is not served) this might not be a practical idea for some of the existing structures. For instance, consider a restaurant having its main entrance facing West and located in the SW corner (Figure 1). Changing the location of this door might not be feasible because of the cost and the required permits from the landlord and the city.

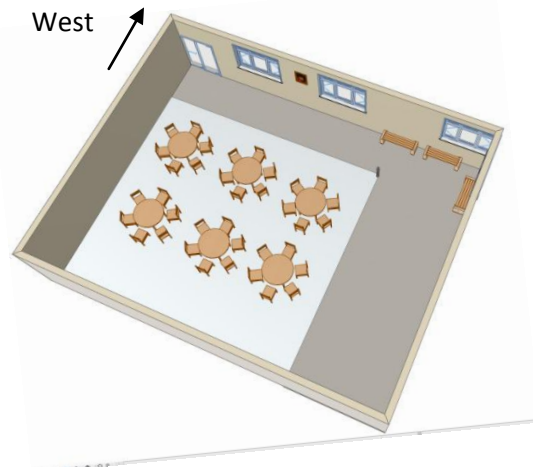

Figure 1. Restaurant with an entrance door in South West corner

The business, as shown in Figure 1, will be a source of tension and anxiety to the owner. The expenses and effort will exceed the net income. Under the given constrain (i.e. the location of the entrance door cannot be changed), the below are some effective solutions that can be implemented to bring in more Vaastu strength.

Figures 2 illustrate two solutions. Both will ensure that the customer will walk towards north before entering the main area. Depending on your budget, you can either place a series of plants or have a separation wall. The length of this wall should be atleast 50% of the total available length. The wall/plant height can be fixed such that the entrance door is not visible to the customers who are inside. Any other interior Vaastu strengths will complement this solution. Ensure that the cash register is opened towards North direction.

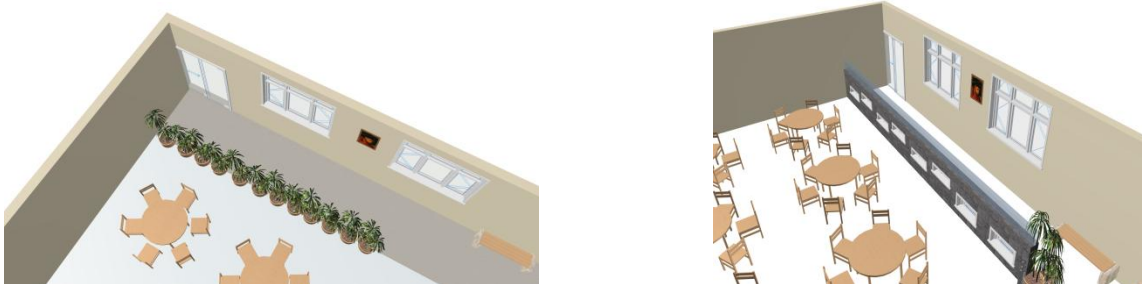

Figure 2. Solutions to improper entrance door location.